

# ÜBERSICHTSZEICHNUNG

ASSEMBLY DRAWING

**GHOST**



VIOLENT ROAD RAGE 7.8, 5.8 & ROAD RAGE 4.8, 3.8, 2.8 (MY19)

V01

# ÜBERSICHTSZEICHNUNG

## ASSEMBLY DRAWING

# GHOST

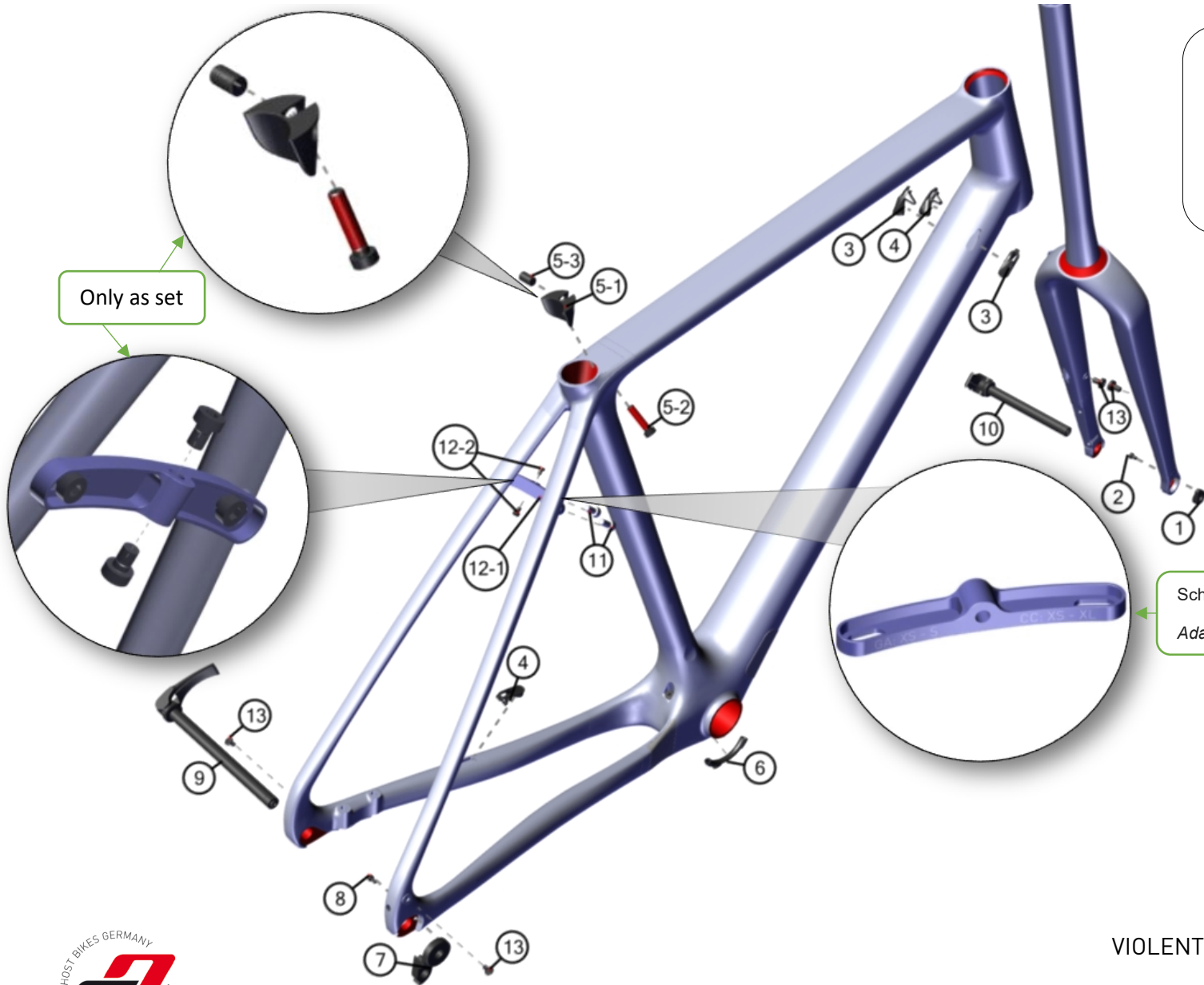

Only as set

**Hinweis:** Bei Schrauben muss mittelfeste Gewindesicherung verwendet werden.  
**Rote Flächen müssen gefettet werden.**

**note:** use medium strength screwlock for screw threads.  
**red surfaces have to be greased.**

Schutzblechadapter ist optional bestellbar  
 Adaptor for fender mount can be ordered separately



VIOLENT ROAD RAGE 7.8, 5.8 & ROAD RAGE 4.8 (MY18)  
 V01

# ÜBERSICHTSZEICHNUNG

## ASSEMBLY DRAWING

# GHOST

BOM-ID	Description	Specification	Torque	Item no.	QTY
1	nut a2t fork	AL7075		FRNT0003	1
2	screw for nut a2t fork	Hex 3 - M4 x 6mm - Stainless Steel	0,8 Nm	FRSC0005	1
3	cable guide plug ø4 mm for shift cable	PA66		FROT0034	2
4	cable guide plug ø5 mm for brake cable	PA66		FROT0035	2
5-1	sp wedge	AL7075		SC0002	1
5-2	sp wedge screw	Hex 4 - M6 x 25mm - Stainless Steel	8 Nm	SC0002	1
5-3	sp wedge cross-thread bolt	AL7075		SC0002	1
6	fd cable guide bottom bracket	PA66		FROT0036	1
7	rear derailleur hanger a2t	AL6061		FRHG0003	1
8	screw for rear derailleur hanger a2t	Hex 2,5 - M3 x 6mm - Stainless Steel	0,8 Nm	FRSC0003	1
9	Token QC AXLE A2T-12, 12mm for Martec Frame			WAX0007	1
10	Token QC AXLE A2T-12, 12mm for Martec Fork			WAX0008	1
11	Schraube Zylinderkopf	HEX 4 - M5 x 12	5 Nm	SM1492	2
12-1	fender mount adapter set			FROT0030	1
12-2	fender mount adapter set			FROT0030	1
13	button head screw	T25 - M5 x 11mm	5 Nm	SM0919	4
	spare parts set			FROT0002	
	<b>set includes following parts:</b>				
	chain protector down tube PTR144				
	DI2 Plugs: OS286 1pc / CS190 1pc / CS189 1pc				
	fd cable guide bottom bracket OS635 1pc				
	DI2 battery holder: OS561 1pc				
	Open SP40 ferrule OS677 1pc				